

See drawing no DT-TF-7001 for typical eaves detail

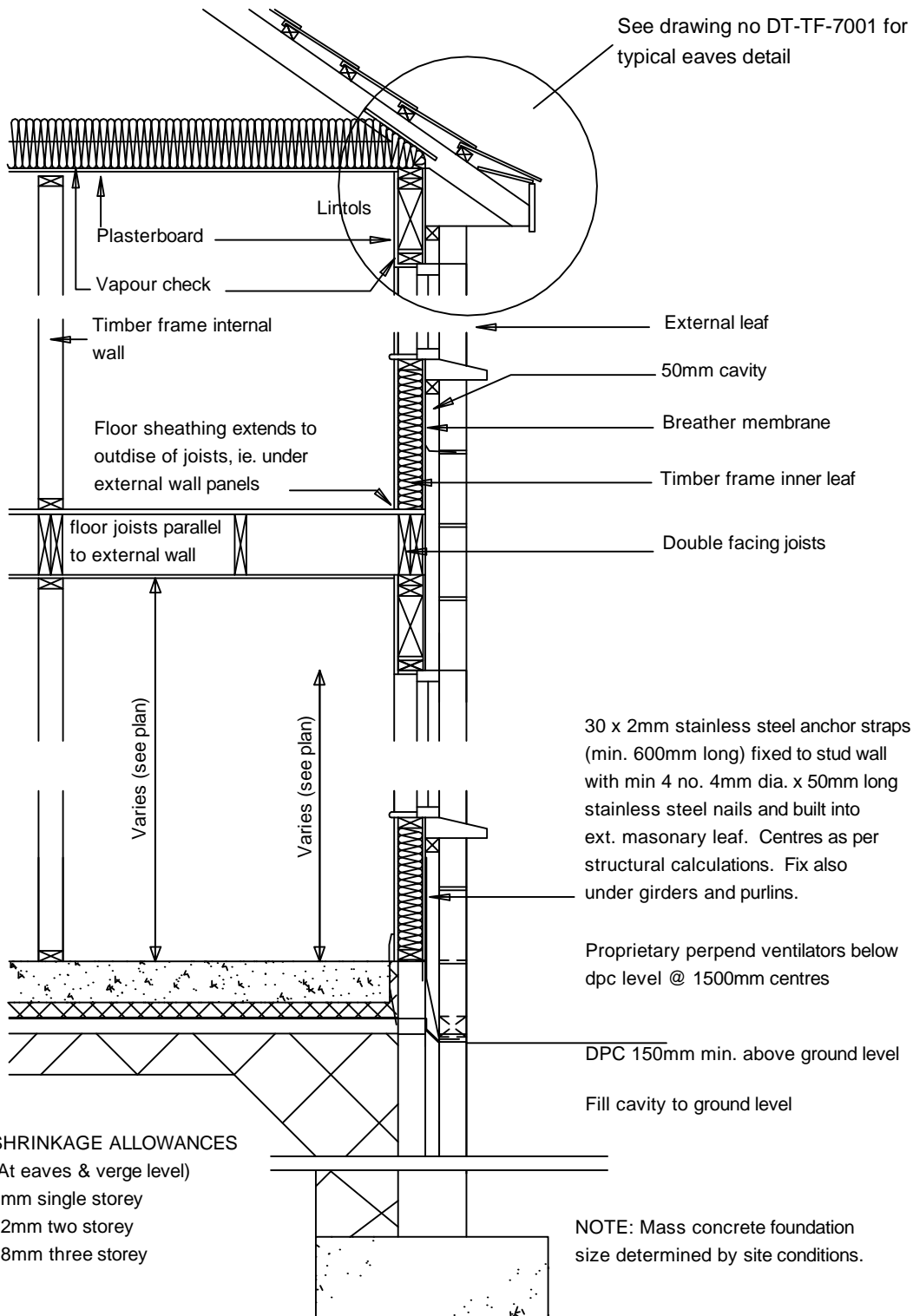

200mm  
glass fibre

See drawing no DT-TF-7001 for  
typical eaves detail

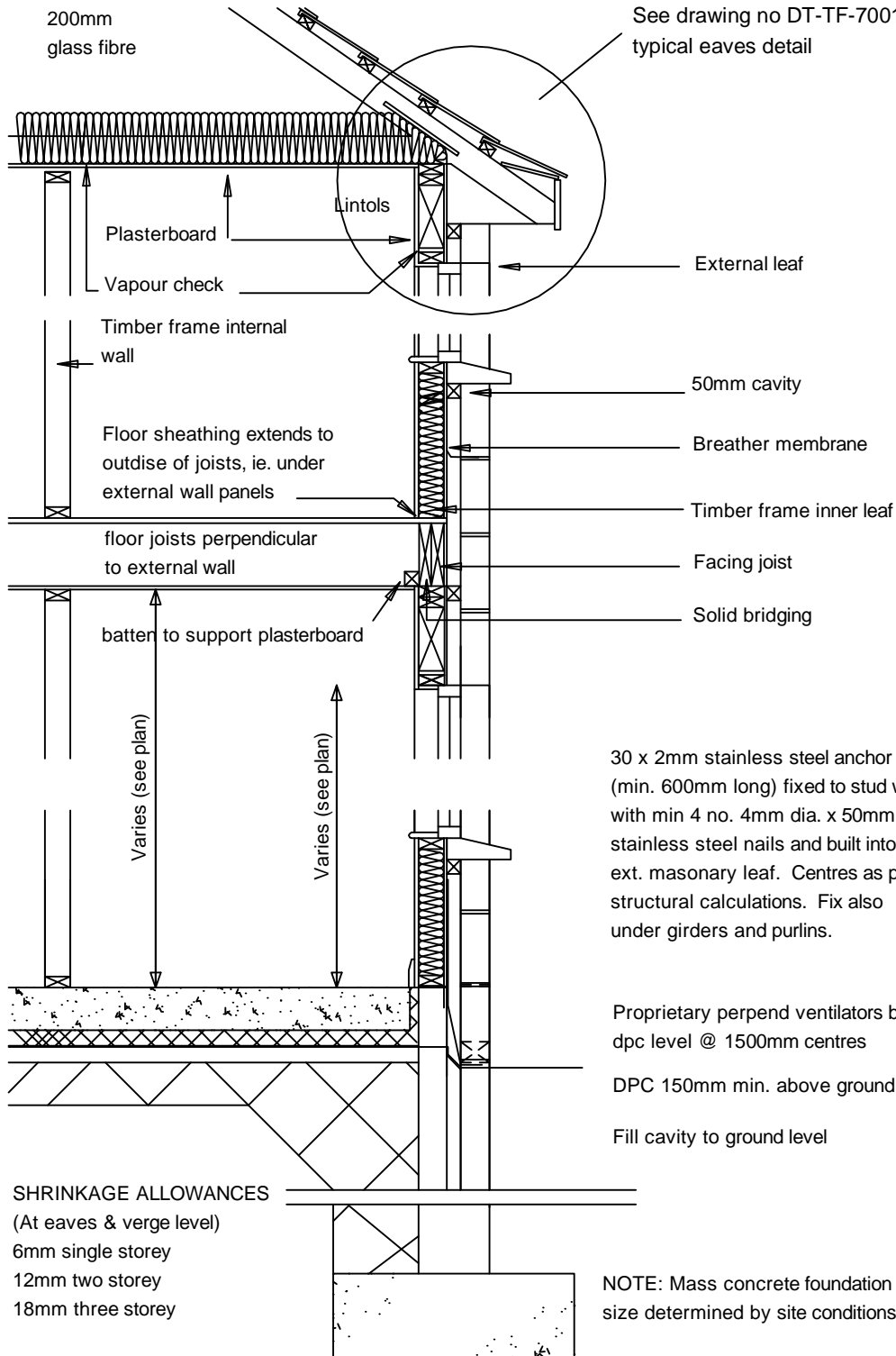

External leaf

Timber frame internal  
wall

50mm cavity

Floor sheathing extends to  
outside of joists, ie. under  
external wall panels

Breather membrane

floor joists perpendicular  
to external wall

Timber frame inner leaf

batten to support plasterboard

Facing joist

Solid bridging

Varies (see plan)

Varies (see plan)

30 x 2mm stainless steel anchor straps  
(min. 600mm long) fixed to stud wall  
with min 4 no. 4mm dia. x 50mm long  
stainless steel nails and built into  
ext. masonry leaf. Centres as per  
structural calculations. Fix also  
under girders and purlins.

Proprietary perpend ventilators below  
dpc level @ 1500mm centres

DPC 150mm min. above ground level

Fill cavity to ground level

**SHRINKAGE ALLOWANCES**

(At eaves & verge level)

6mm single storey

12mm two storey

18mm three storey

NOTE: Mass concrete foundation  
size determined by site conditions.